

MISSOURI GEOGRAPHIC
REFERENCE SYSTEMMISSOURI DEPARTMENT OF NATURAL RESOURCES
DIVISION OF GEOLOGY AND LAND SURVEY
LAND SURVEY PROGRAM
P. O. Box 250
Rolla, Missouri 65402
(573) 368-2300

STATION NAME: CSL-11 RESET

PID: AA8571

STATE: Missouri

COUNTY: City of St Louis

TOWNSHIP: 45 NORTH,

RANGE: 7 WEST, SECTION: USS

USGS 7.5' QUAD: Clayton

NGS QUAD. OR QIDQSN: 38090131

DATE MONUMENTED: 1990

MONUMENTED BY: MODNR

TECHNICAL DATA TABLE:

(All data in meters 1 meter = 3.28083333 feet)

HORIZONTAL: NAD 1983**VERTICAL:** NAVD 1988

DATE OF OBSERVATIONS: 1990

DATE OF OBSERVATIONS:

DATE OF ADJUSTMENT: 2000

DATE OF ADJUSTMENT:

ORDER: 1st

ORDER:

LATITUDE: 38°37'55.98753"

ELEVATION: 155.3

LONGITUDE: 90°15'37.28150"

STANDARD DEVIATION:

STANDARD DEVIATION:

ELLIPSOID HEIGHT:

MISSOURI COORDINATE SYSTEM 1983:

NORTH (Y): 310632.636

EAST (X): 270865.163

ZONE: East

CONVERGENCE: +00°08'58.6"

GRID FACTOR: 0.9999192

AZIMUTH INFORMATION:

STATION: CSL-11

AZIMUTH MARK: CSL-11A

GEODETIC:

ASTRONOMIC: 109°57'36.8"

GRID: 109°48'38"

REMARKSThe HORIZONTAL POSITION was determined by GPS observations and
adjusted by the National Geodetic Survey in 2000The AZIMUTH was determined by observation of Polaris with an estimated
accuracy of 1 second of arc

The ELEVATION was determined by GPS observations

The ELLIPSOID HEIGHT was determined by GPS observations referenced to
NAD83

GEOID 99 was used in determining ELEVATION and/or ELLIPSOID HEIGHT

Date of Report 2001

STATION: CSL-11 Reset

DESCRIPTION: CSL-11, 1990 disk was damaged. CSL-11 RESET, 1997, disk was set in original position. The station and azimuth mark are standard disks grouted in drill holes in the sidewalk slab.

STATION, AZIMUTH MARKS AND REFERENCE TIES: The station is located in the sidewalk slab of the NE abutment of the Taylor Avenue overpass of US Hwy 40. It is 4.9 ft. south of the north end of the slab; 3.6 ft. east of the east curb; 25.00 ft. south of 'x' cut in curb; 1.88 ft. ESE of the face of wall; and 10.6 ft. SW of a carsonite witness post.

The azimuth mark is 0.3 mile east of the SW abutment of the Tower Grove Avenue overpass of US Hwy 40. It is 5.7 ft. north of the south end of the slab; 2.47 ft. west of the west curb; 2.62 ft. east of face of wall; 10.86 ft. NE of a nail and shiner in the west side of a power pole; and 8 ft. NE of a carsonite witness post.

STATION & AZIMUTH MARK TO REACH: To reach the station from the center of I-44 Exit 287 (Kingshighway), (Exits only from west going east), go north on Kingshighway for 0.5 mile to traffic light intersection with Manchester Road. Turn right and go east on Manchester for 0.2 mile to traffic light intersection with Taylor Avenue. Turn left and go north on Taylor for 0.4 mile to station site on right (east) as described in sidewalk of NE abutment of US Hwy 40 overpass.

To reach the azimuth mark from the station, continue north on Taylor Avenue for 0.05 mile to Clayton Avenue. Turn right and go east on Clayton for 0.3 mile to Tower Grove Avenue. Turn right and go south on Tower Grove for 0.15 mile to azimuth mark on right (west) side at south end of US 40 overpass as described.

SPECIAL INFORMATION:

SUPERSEDED SURVEY CONTROL

NGS (1997) LAT: 38°37'55.98822" LONG: 90°15'37.28160"
 MODNR (1995) LAT: 38°37'56.00305" LONG: 90°15'37.27775"
 MODNR (1993) LAT: 38°37'56.00314" LONG: 90°15'37.27736"

DATE of REPORT 2001

STATION: CSL-11, 1990

CUT CROSS
IN CURB
25.00'

SHEET 3 OF 3

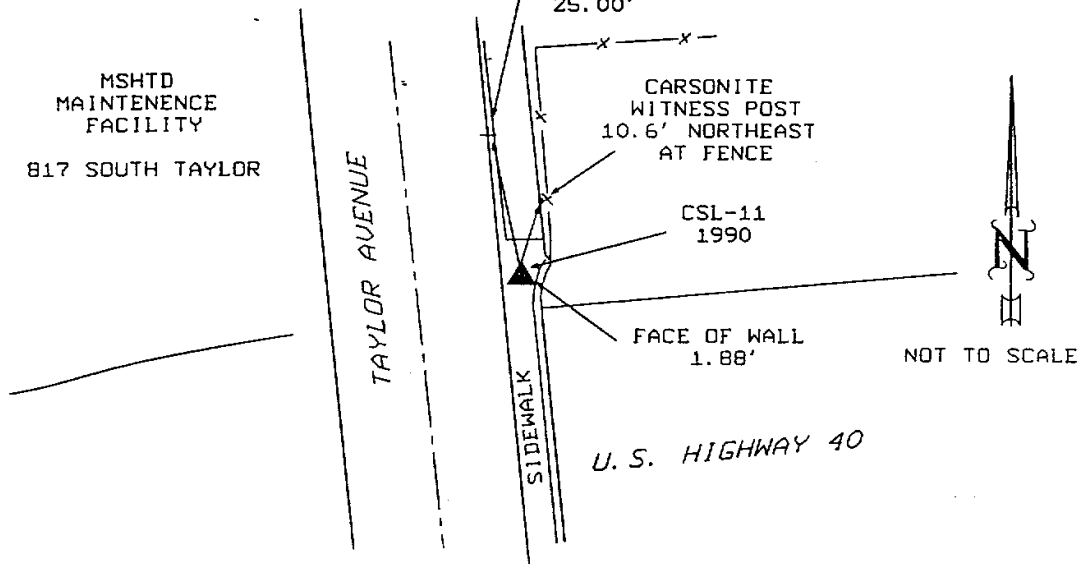

AZIMUTH MARK: CSL-11 A, 1990

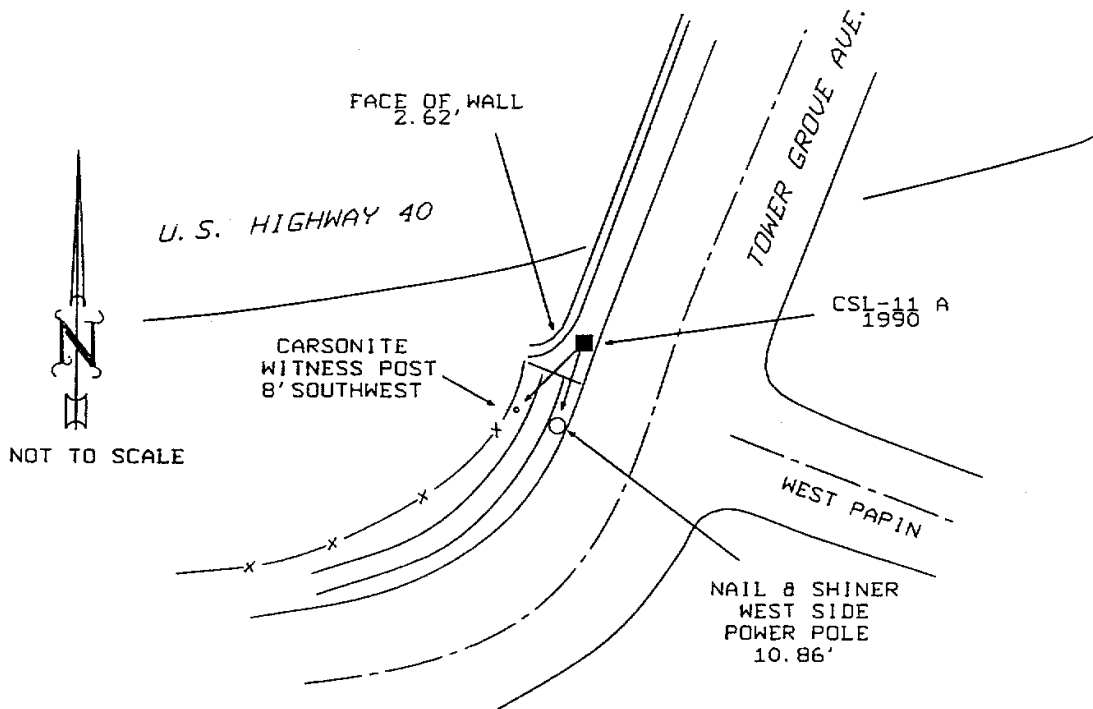

DATE OF SKETCH 1990